

October 2004

City of Burien, Washington

**Salmon Creek
Neighborhood Plan**

TABLE OF CONTENTS

<u>CHAPTER</u>		<u>Page</u>
	ACKNOWLEDGEMENTS.....	3
1.0	VISION STATEMENTS.....	4
2.0	INTRODUCTION and BACKGROUND	5
3.0	NORTHWEST NEIGHBORHOOD HISTORY.....	7
4.0	DESCRIPTION OF THE NORTHWEST NEIGHBORHOOD....	11
5.0	HOUSING.....	13
6.0	PEOPLE OF THE NEIGHBORHOOD.....	14
7.0	TRANSPORTATION.....	14
8.0	NATURAL ENVIRONMENT.....	17
9.0	PARKS AND OPEN SPACE.....	19
10.0	PUBLIC SAFETY.....	24
11.0	APPENDICIES.....	25

ACKNOWLEDGEMENTS

The City of Burien would like to thank the residents of the Salmon Creek neighborhood and the following citizens who participated in the City of Burien's first Neighborhood Plan. Without the efforts of these dedicated citizens and volunteers this plan would not have been possible. The City acknowledges the support of the following individuals and groups in development of this Neighborhood Plan:

Steering Group Members and participants:

Jon Newton	Mel Sturman
Bob Edgar	Gene and Warren Pugh
Toni Lysen	Rose Clark
Shirley Farley	Stephen Tomoshok
George Thornton	Judy Pickins
Sally Ganong	
Laurie Strong	

The City Council

Mayor, Noel Gibb
Deputy Mayor, Sally Nelson
Councilmember, Jack Block Jr.
Councilmember, Stephen Lamphear
Councilmember, Lucy Krakowiak
Councilmember, Joan McGilton
Councilmember, Gordon Shaw

City of Burien Staff

Gary Long, City Manager
Scott Greenberg, Community Development Director
Larry Fetter, Parks and Recreation Director
David Johanson, Senior Planner
Dan Bath, Public Works Engineer
Kirsten Pennington, Transportation Planner
Susan Coles, Administrative Assistant
Joe Wallis, Planning Consultant
Scott Kimerer, Police Chief
Scott Lavielle, Fire Marshal, North Highline Fire District

1.0 VISION STATEMENTS

The Salmon Creek Neighborhood is to be an open and accepting place that fosters supportive and trusting interactions of neighbors that promotes continuing interest in each other as vital members of the neighborhood.

There is to be mutual support in the neighborhood that is based on a shared sense of community.

The Salmon Creek Neighborhood should be a healthy neighborhood that includes adequate parks, high standards of public safety, high quality multi-modal transportation and a sense of heritage that will be mutually identified and supported by residents of the neighborhood for the benefit of all.

2.0 INTRODUCTION and BACKGROUND

neigh-bor-hood (na' ber-hood), *n.* 1. the region surrounding or near some place or thing; vicinity. 2. a district or locality, often with reference to its character or inhabitants. 3. a number of persons living near one another or in a particular locality. 4. neighborly feeling or conduct.

2.1 WHY NEIGHBORHOOD PLANNING?

In 1999, city wide Comprehensive Plan policies were adopted directing the development of neighborhood plans to reinforce and enhance the City's well-established neighborhoods. The City of Burien Comprehensive Plan established the overall vision and framework for development of policy decisions in the City Neighborhood plans to address the unique characteristics and concerns of individual neighborhoods while remaining consistent with the established Comprehensive Plan. In March of 2001 the City Council unanimously approved a neighborhood planning pilot project beginning with the northwest neighborhood.

Neighborhood planning is pro-active approach to building quality neighborhoods. It is intended to establish links between decision makers and citizens. These links empower persons to express wishes and needs for a neighborhood so that decision makers can more effectively use the community's resources invested in a neighborhood.

In August of 2002 the Neighborhood Planning pilot project began with the mailing of a newsletter informing the neighborhood of the upcoming project and soliciting volunteers to become involved. The Northwest Neighborhood Steering Group was formed in November 2002 and began a series of monthly meetings studying the topics and developing the neighborhood plan. Throughout the process specific topics were discussed in detail and the steering group provided valuable initial input on the desires of the neighborhood.

The plan was developed in a draft form and a public meeting was held to obtain further input of the entire neighborhood. This was an opportunity to "check in" with the neighborhood to ensure that the plan included all concerns and/or desires were adequately addressed. At the community meeting, participants were asked if the neighborhood should be recognized as the "Salmon Creek Neighborhood" to reflect the natural streams that constitute the drainage basins of the neighborhood. The response at the meeting confirmed the recommendation of the Steering Group that the northwest neighborhood be recognized as the Salmon Creek Neighborhood.

This neighborhood plan is meant to be inclusive of all community members, not exclusive – everyone's voice should be heard and considered with equal merit. This plan is the direct product of the neighborhood planning process and serves as a valuable resource for decision makers. To be the best plan possible and represent the needs and desires of the entire neighborhood, it is imperative that the community be actively involved in the process, not just a Steering Group. It also serves as an informational resource to existing and potential new residents to the area. The document represents the vision and values of the northwest neighborhood.

2.2 NEIGHBORHOOD PLANNING TERMINOLOGY

Each of us perceives our neighborhood or city from our individual perspective. And while each citizen sees his / her neighborhoods from a unique vantage point, there is general consensus in our perceptions of how we would like our neighborhood to look and function.

In drafting the neighborhood plan, it is vital that a common language be used to describe idealized perceptions developed by consensus. The language used must provide a common and consistent direction to guide decision makers as they make incremental decisions that affect the future of the neighborhood.

The terms and definitions below are provided here to establish the structure for expressing citizen consensus for the neighborhood plan.

Vision – as used in neighborhood planning is an idealized, *general* perception of the neighborhood at some *unspecified future date* (i.e. ideally, what do citizens wish their neighborhood to become in the future so that short term incremental decisions are consistent with the *vision*).

Goals - address *longer-term, quality* objectives for a particular issue or subject. (i.e. Recreation facilities provided by the city are to serve the recreation needs of all citizens of the neighborhood.)

Policies – are *shorter-term* objectives that are *measurable* and have a *schedule* for accomplishment. (i.e. The amount of recreational space provided by the city for the neighborhood is to meet the national parks standards as measured in area per neighborhood citizen by the year 2005.)

Typically there is a single vision statement of the neighborhood plan that addresses the overall desired conditions of the neighborhood.

The number of goals depends on the neighborhood characteristics and issues that citizens of the neighborhood wish to address.

The number of policies is related to the number and complexity of goals of the neighborhood as chosen by residents of the neighborhood.

3.0 OUR EARLY HISTORY

1741-43

Russian explorers reach Alaskan islands and coast and trade with native peoples for sea otter pelts.

1774

Juan Perez commands the first Spanish expedition to explore the Northwest Coast and sights the Olympic Mountains.

1775

Bruno de Hezeta lands on the Washington coast and claims the area for Spain. On his return south, he sees the mouth of the Columbia River.

1778

James Cook (British) explores and charts the Northwest Coast.

1789

George Washington is elected the first president of the United States.

1792

Robert Gray (American) names the Columbia River after his ship.

George Vancouver (British) explores and names Puget Sound and Lieutenant William Broughton explores the Columbia River up to Point Vancouver.

Spain establishes the first non-Indian settlement in Washington at Neah Bay.

1805-06

Lewis and Clark enter Washington and stay at Fort Clatsop on the south side of the mouth of the Columbia River.

1807-11

David Thompson charts the Columbia River.

1825

Hudson's Bay Company establishes forts Vancouver and Colville on the Columbia.

1841

United States naval expedition, headed by Charles Wilkes, explores Washington.



While information presented here expands the scope outside our neighborhood, it is presented as relevant information to understand the dynamics of our neighborhood's role in the early development of King County and the City of Burien.

White settlement of the Puget Sound area began in 1851, when David Denny (1832-1903), John Low (1820-1888), and Lee Terry (d. 1889) arrived at the mouth of the Duwamish River. Denny and Low were part of the Denny Party that traveled over the Oregon Trail from Indiana to Portland, but found Oregon's Willamette Valley already too crowded for its taste. The two had been sent north to scout the Puget Sound area, and met Terry along the way.

Low and Terry staked claims along Alki Beach, in what is now West Seattle, shortly after their arrival in September 1851. Low returned to Portland with a note from David Denny urging his older brother, Arthur Denny (1822-1899), to "come at once." Heeding that advice, the Denny Party landed at Alki Point on Nov. 13, 1851.

Following a winter buffeted by rough weather, most of the Denny Party relocated in the spring to the relatively sheltered shore of Elliott Bay, on the site of present-day Pioneer Square. Charles Terry (1830-1867) remained and dubbed his claim New York Alki in the Chinook jargon, which translated to New York By and By.

Between May 23, 1857, and February 9, 1858, near the end of the Yakima Indian War, a contract survey of the Burien area was conducted and submitted to the surveyor general of the Washington Territory. A few years later, in 1860, gold was discovered in the Okanogan. The Civil War erupted shortly thereafter, slowing settlement of the West.

Following the Civil War and the Reconstruction, America resumed its dreams of westward expansion. The completion of the Northern Pacific Railway in 1883, linking Tacoma to the East, opened the door to greater migration into Washington Territory. The territory achieved statehood in 1889.

Movement South from Seattle

Thirteen years after the Denny Party landed, the first transfer of coastal land, 70.55 acres, was made to George Oulett, a single man aged 32 years (*document 159*) under a cash sales entry dated Dec. 9, 1864. His parcels consisted of most of today's beach front on Burien's northern coastline. Oulett has the distinction of being the first landowner along Burien's coast and inland. His land ownership precedes any other in the area by more than four years.

1843

First large immigration to Oregon occurs and temporary government established.

1846

Treaty between United States and Great Britain sets boundary at 49th parallel.

1847

Cayuse Indians attack Whitman Mission in Walla Walla.

1848

Oregon Territory created.

1851

First settlers land on the site of Seattle.

1853

Washington Territory created.

1855-58

Yakima Indian War

1855

Walla Walla Treaty Council.

1860s

Gold and silver discovered in the Okanogan.

1883

Northern Pacific Railroad completed to Tacoma, linking Washington to the East.

1886

Coal mining town of Roslyn founded; Mine operated by the Northern Pacific Coal Company.

1888

Stampede Tunnel of the Northern Pacific Railroad completed across the Cascades.

1889

Washington becomes the 42nd state.

1893

Great Northern Railroad completed to Seattle.

1897-99

Klondike Gold Rush; Seattle grows quickly as a jump-off point for people heading to the gold fields.

1899

Mount Rainier National Park established.

1900

Frederick Weyerhaeuser sets up a logging business in western Washington.

Pioneer Profile: George Oulett in the 1880 Census

George Oulett, a 48-year-old farmer born in Canada to parents of Canadian birth, and his 24-year-old wife, Elizabeth, were living in Milton Precinct, King County, with their young family of four children in 1880. Elizabeth was born in 1856 in Washington to a German immigrant father and a mother who was born in Washington. Of the Oulett's children, Thomas, born in 1871, was the oldest at 9 and was attending school. Frances, born in 1874, at 6 was nearly school age (m. 15 Feb. 1906 to Albert Albin Kalin in Victoria, B.C.). Josophene was 3, and the youngest daughter, Maud, was a mere 5 months old.

(U.S. Bureau of the Census, Tenth Census – 1880, Vashon and Maury Island, Milton Precinct, King County, Washington, roll T9-1396, page 263-264, National Archives.)

Northwest Burien's Earliest Pioneers

Other early settlers soon followed Oulett. On May 15, 1869, three enterprising men purchased what is most of today's Seahurst Park: A.F. Pope, W.C. Talbot, and Cyrus Walker (*document 1553*). By 1880 (census), Cyrus Walker, by then age 52 and still single, was a lumber mill company manager on the Kitsap Peninsula.

On Sept. 9, 1870, John G. Parker purchased a foothold of 9.7 acres along the shore at the mouth of Salmon Creek (*document 2344*). C.P. Stone acquired 37.25 acres of shoreline property adjoining Oulett's northern boundary (*document 2675*) on Oct. 10, 1871.

The remainder of Section 12, Township 23 North, Range 3 East stayed vacant for another 18 years. On March 8, 1889, William J. Blackwell purchased 100.65 coastal and inland acres in Section 13 immediately to the south of Oulett's parcel (*document 10352*). Several months later, on August 8, 1889, Charles Kennett and John Lavender purchased 120 acres each. These were the next inland parcels from Stone and Oulett's parcels. Land sales seemed to move from the shoreline inland. On the 31st of the same month Charles Peacock bought the remaining 160 acres in the northwest section of T23-R3E (see Map on page 8). A more detailed list of property owners can be found in the appendix (Section 11.1).

Samuel B. Carr and Thomas Hood began the first logging operation in what is now the Northwest neighborhood sometime around 1887 on land owned by the Kakeldies on Seola Beach. The operation worked its way up what is now Seola Beach Drive onto the White Center plateau, immediately north of our neighborhood. In 1891 they began operations in Salmon Creek but gave up after a year due to the steep and wet hillsides. They left and moved to the vicinity of Oak Park, which they cleared and subdivided.

Access into the shoreside areas that were to become our neighborhood was not really possible until logging had cleared much of the plateau above. The first roads were for the timber operations and went from the beachhead at Seola Beach up the hill onto the plateau and over to the top of the ridge near Myer's Way. This was the early land link with the rest of Seattle. A few rough and muddy roads swept to the east and came in to Edward S. Solomon's parcel, 319.68 acres encompassing what is now known as the Mayfair and Hermes Depression. The timber in our neighborhood fed the mills in White Center producing logs suitable for local building and shingle mills. Development activities during this era consisted of clearing the land, selling the timber and then settling the land, all while providing from \$1 to \$3.50 a day for logging as long as the sun was up.

The coming of the railroad opened up new stands of timber. In 1905, the Washington Timber and Logging Company ran a railroad from Seola Beach to a round house at 28th Avenue Southwest and Roxbury. Another rail line ran from Highland Park to Greendale and on to Hick's Lake. The remnants of the cement pillars that supported the log dumping end of the logging railroad can be seen on Seola Beach to this day. Although the actual rail lines were not located in our neighborhood, they are significant to note as they significantly contributed to accelerating development of the area. As logging opened and cleared an area, the land was subdivided into 5-, 10- and 20-acre parcels for the next wave of settlers. The farmers and land holders worked and cleared land, creating more usable acreage. The resulting pioneer farms were further subdivided in the 1930s, '40s and '50s.

The Early 21st Century

In the early 21st century all the land had been bought and the latest wave of settlers were bringing the village of Burien into the new century. The area was still difficult to reach and many settlers continued to use the abandoned logging roads. In 1909, Jacob Ambaum was contracted to blaze a right-of-way for a new north-south road from White Center to Burien. This slice through the timber was to become Ambaum Boulevard. Although a vital connection between the two village centers, it was an unending river of mud through a very solid corridor of fir trees. Looking at a picture taken in 1909, it seems like the trees are second growth timber 40-50 years old.

Ambaum Boulevard remained unsurfaced until 1921, when it was paved as far as Southwest 112th Street. The road was widened in the 1950s to accommodate the increased traffic from local

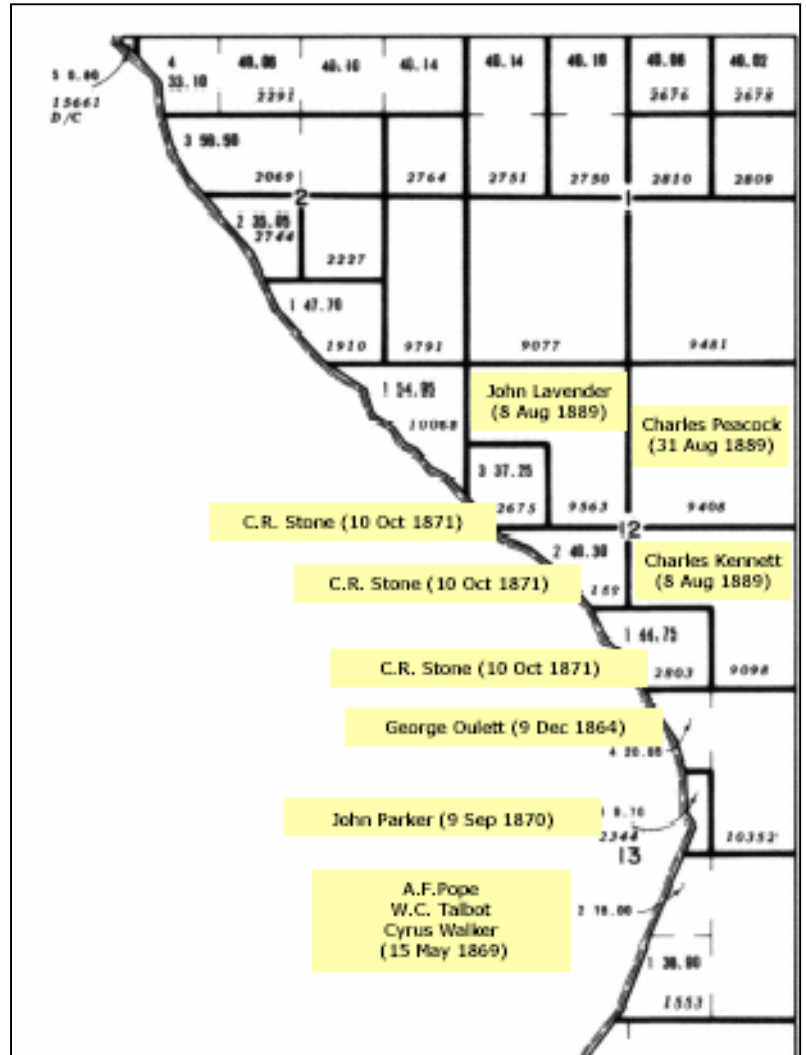

housing developments. A multi-million dollar paving and utilities improvement project was completed late in 1977, resurfacing and widening Ambaum Boulevard from White Center to Burien and creating the modern day four-lane north-south arterial between Burien and Seattle.

Prior to the establishment of a developed road system, the remote nature of our area became a convenient home to some “back-door” activities passing through from Puget Sound on the way to the now bustling Seattle. Notably there was smuggling of opium, labor and liquor from points on the Puget Sound coast connecting with a trail that was to become Myers Way, which terminated at the Duwamish tide flats. The operation of stills and rum-running peaked in the Prohibition years.

The area mostly had been settled and more and more people were finding Burien a great place to in which to live. One of the oldest buildings still standing, located at 3307 SW Seola Lane, was built on the beach on what was C.P Stone’s parcel in 1918. The building that today is Mario’s Sports Bar, at the southwest corner of Ambaum Boulevard Southwest and Southwest 128th Street, was built in 1928.

By 1930, much of the land around Lake Burien and north along the coast was purchased and assembled into a large estate called *Glennallen*. Jay C. Allen was a prominent Seattle lawyer, much respected and with a lucrative practice. His wife, Larah, was a successful business woman. She handled most all their investments and especially the real estate – it was her passion. By 1935, at the time of her untimely death from an apparent heart attack, she had assembled more than 400 acres of connecting parcels extending from Lake Burien up the coast to the northern edge of present day Burien, and owned several blocks in downtown Seattle. Following her death, her beloved *Glennallen* was broken up and gradually sold off. Development continued in the downtown Burien area but the coastal areas still were not fully developed, partly due to the steep slopes.

The northwestern area overlooking Puget Sound in George Oulett’s original parcel was developed in the early 1940s. The Second World War made building materials scarce so several of the early residents built the garage first and lived in it until the war ended and materials again became available. The coastal area north of Salmon Creek “Gulch” saw its greatest construction throughout the early 1950s and early 1960s. This was much the same peak period of growth for the entire area. The Juanita and Mark Manor apartments along Ambaum Boulevard went up in the mid 1960s. By the middle 1970s most all of the currently developed area was built upon.

Goal HI 3.1 Salmon Creek Neighborhood History

Increase history awareness and knowledge within and about the neighborhood.

Policy HI 3.1.1 Historical plaques or markers should be placed along trails or paths indicating sites or events of historical significance.

Policy HI 3.1.2 Use historic context to recommend names of tributaries and streams that currently do not have names in the neighborhood.

4.0 DESCRIPTION OF THE NORTHWEST NEIGHBORHOOD

The Salmon Creek Neighborhood is situated in the northwest corner of Burien which is a suburban City located approximately 10-minutes from downtown Seattle. The Salmon Creek neighborhood is bounded by SW 116th Street on the north, Puget Sound to the West, Ambaum Boulevard on the East and Seahurst Park on the South, See Map 1.0.

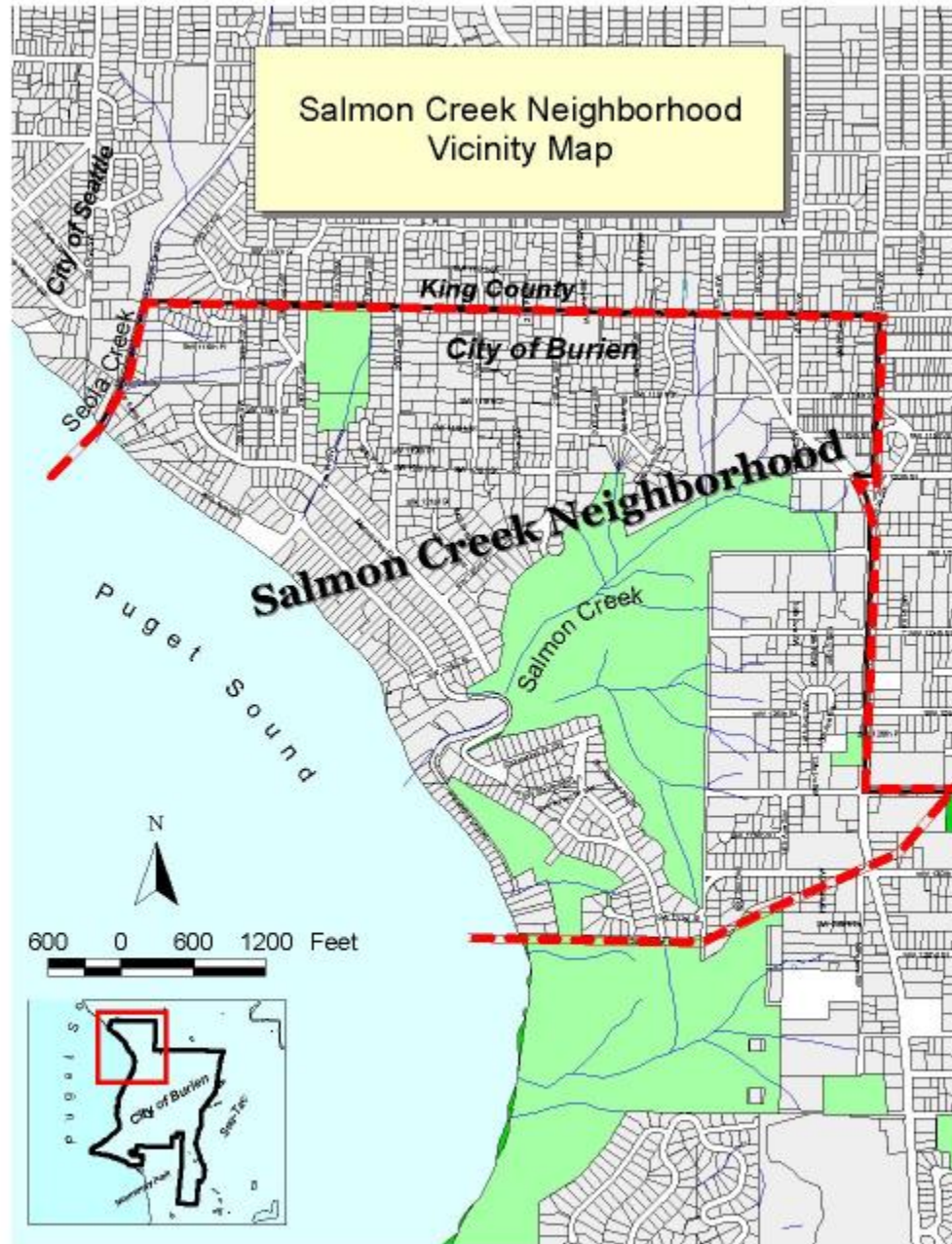

City of Burien, Washington
Salmon Creek Neighborhood Plan **Map 1.0**

--- Salmon Creek Neighborhood Boundary

The Salmon Creek Neighborhood is demographically diverse with a variety of age groups, family sizes, and ethnic groups. Along with the population diversity there are housing variations as well, including a mix of residential dwelling types. Residential housing types include high value single-family waterfront and view properties along with modest valued typical suburban developed single-family dwellings. There also are a number of multi-family developments that range from town home style to larger apartment complexes that are generally located in the vicinity of Ambaum Boulevard Southwest.



Picture 1.0 (Views of Puget Sound and Olympic Mountains)

Topographically, a large portion of the neighborhood slopes downward to the west toward Puget Sound contributing to the expansive views available throughout the neighborhood (see Picture 1.0). The area contains other distinctive natural features including large natural open spaces that include Salmon Creek preserve, Shorewood Park and Seahurst Park. Located in the center of the neighborhood is the Salmon Creek ravine which is heavily wooded and includes a year round stream and is also home to a variety of wildlife. Another ravine, containing Seola Creek, borders the neighborhood to the north and empties to Puget Sound at an area known as Seola Beach. This portion of the city and the neighborhood share a border with the City of Seattle.

Highline School District provides public education services to the neighborhood. Elementary level education is provided by Shorewood, Hazel Valley and Salmon Creek Schools. Cascade Middle School and Evergreen High School offer public education above the elementary level. There are also a number of private educational entities servicing the neighborhood. See Chapter 11 (appendix) for a detailed list of public and private service providers.

Ambaum Boulevard Southwest is the principle access to the neighborhood. Local streets that conform to the topography of the area serve residents throughout the neighborhood. Several public transit bus routes also serve the neighborhood.

Shopping and day to day services are available within very short distances both to the North in unincorporated King County and to the South in downtown Burien. Businesses in the immediate vicinity that serve the neighborhood are situated along Ambaum Boulevard Southwest and are clustered near the intersections of SW 116th Street and Southwest 128th Street.

5.0 HOUSING

The Salmon Creek neighborhood contains approximately 1,400 housing units of which approximately 75% are single-family residential as compared to the City of Burien which has 14,000 housing units with 61% single-family and 39% multiple-family. The average age of the housing is 44 years old (constructed in 1959) which is slightly newer than the City of Burien (constructed in 1955). See Chapter 11 (appendix) for more detailed housing information.

Goal HO 5.1 Housing

Maintain and promote the highest quality housing for all residents of the neighborhood regardless of economic status.

Policy HO 5.1.1 Incentives to the development community should be judiciously considered to encourage redevelopment of aging or deteriorated housing and improve overall development quality. (i.e. allowing greater density, increased height, mixed use, etc.) The amount and intensity of incentives offered should be directly related to the quality of the design.

Discussion: Steering Group members were asked about the acceptability of providing incentives for improving the quality of housing along and in the vicinity of Ambaum Boulevard SW. The provision of incentives could help to motivate developers to improve development but should not be offered if the design of the site is not of the highest quality.

Policy HO 5.1.2 Resident ownership of housing is strongly encouraged.

Discussion: Resident owners are more highly motivated (to care for and maintain property) by an attitude of stewardship due to the personal investment in property as compared to resident renters.

6.0 PEOPLE OF THE NEIGHBORHOOD

The estimated population of the Salmon Creek neighborhood is 3,373 or nearly 11% of the City's total population. A majority of the residents are white (71%). Asian (10%) and black (6%) are the next largest represented ethnic groups with 12% of the population falling into the category of other. The average age of the neighborhood is comparable to rest of the city. The average income is somewhat lower than the City and King County.

Goal PE 6.1 Neighborhood Relationships

Strive to enhance relationships between single family and multi-family residents of the neighborhood.

Policy PE 6.1.1 Provide opportunities for interaction of diverse ethnic and economic groups within the neighborhood.

7.0 TRANSPORTATION

The transportation system in the Salmon Creek neighborhood primarily consists of a residential roadway network fed by principle arterials (Ambaum Blvd. SW and SW 128th Street). Shorewood Drive and SW 116th Street are neighborhood collectors that feed into the neighborhood from the principles arterials. The remainder of the streets are classified as local access streets. Public transit service is available on SW 116th Street and Ambaum Boulevard SW.

Map 7.1 illustrates locations of the most significant intersections and their existing level of service.

The neighborhood has listed perceived problems and has compiled a list of transportation related concerns. The denoted areas on Map 7.1 indicate the location of the perceived problem areas.

Ref No.	Traffic Safety, Traffic Calming and perceived problem areas
1	Speeding problems down hills (Shorewood Drive SW, 26 th Avenue SW and 21 st Avenue SW).
2	Dangerous site distance and pedestrian conflicts on Shorewood Drive SW at the hairpin above Standing Lane. The gabion wall appears to be failing and there is no safe walking area.
3	The City should install signs at the hairpin corner on Shorewood Drive SW to slow drivers and provide a warning that pedestrians are present.
4	Signal timing eastbound at SW 128 th Street and Ambaum Blvd. SW could be better exiting from the neighborhood.
5	Residents on Shorecrest Drive SW would like a "dead end" at the northern intersection of Shorecrest Drive SW and Shorewood Drive SW.
6	Westbound SW 130 th Street to Ambaum Blvd. SW is very busy. There are safety issues when turning to and from SW 130 th Street crossing Ambaum Blvd. SW. The intersection should have a center lane.
7	Concern regarding pedestrian safety at SW 128 th Street and Ambaum Blvd. SW
8	Concern that vegetation is obscuring overhead street lights. Vegetation should be pruned.



City of Burien, Washington
Salmon Creek Neighborhood Plan

June 2004

MAP 7.1

- Intersections of Interest
- Salmon Creek Neighborhood Boundary
- Trail
- City of Burien Boundary
- Stream
- Potential Problem Areas

Pedestrian/Bicycle Circulation

At the time this plan was being prepared the City was also developing a bicycle and pedestrian circulation plan containing specific recommendations and details on those types of facilities within all areas of the City. The Steering Group discussed the issue of road standards and pedestrian facilities. The Steering Group concluded that the results of the City wide Pedestrian and Bicycle Facilities Plan should be used and hereby reference the plan in this document.

Goal TR 7.1 Transportation

Provide a system of safe, accessible, useable walking and bicycle routes throughout the neighborhood that connect to transportation and public transit nodes and main thoroughfares.

Policy TR 7.1.1 Support and encourage education for pedestrian and bicycle safety.

Policy TR 7.1.2 Major internal circulation routes within the neighborhood should include facilities for pedestrians and bicycles. Whenever possible, bicycle travel ways should be separated from pedestrian walking areas.

Policy TR 7.1.3 Street utilities installation for (1) upgrading existing utilities and (2) utilities to be newly under grounded are to be coordinated with street improvements to minimize street disruption and deteriorated street surface quality.

Policy TR 7.1.4 The Salmon Creek Neighborhood supports the undergrounding of overhead utilities. Whenever possible overhead utilities should be undergrounded.

8.0 NATURAL ENVIRONMENT

The natural environment of the Salmon Creek neighborhood in northwest Burien is comprised of a variety of natural features including Puget Sound shorelines, streams, wetlands, and varying degrees of steep slopes. This variation in the environment adds to the diversity of the wildlife bordering and within the neighborhood. A variety of wildlife can be found in Salmon Creek ravine which contains approximately one mile of stream and little over one mile of tributaries, some of which are spring fed. Animals common to the ravine include raccoon, red fox, muskrat bats and grey squirrels.

Much of the neighborhood is perched approximately 200-feet above Puget Sound and slopes upward to a highest elevation of approximately 400-feet above sea level. The undulating topography contributes to the expansive views ranging from the northwest to the southwest. At the base of the steep slopes is the Puget Sound which runs the length of the western boundary of the neighborhood for approximately one-mile. Almost the entire length of the Salmon Creek Neighborhood shoreline is armored with protective bulkheads.

The uniqueness of the neighborhood topography is also reflected in the area being shared by three (3) stormwater drainage basins. On the southern portion is the Salmon Creek Drainage Basin, which is the largest of the three. Moving northward is the outlet for a portion of the Lower Puget Sound Drainage Basin and at the very northwestern tip of the neighborhood is the Seola Creek Drainage Basin. Seola Creek is located at the northwestern most tip of the neighborhood and divides the City of Burien and City of Seattle corporate boundaries.

The following are a few facts pertaining to the natural environment found within the Northwest Neighborhood:

- **Shorelines**
1-mile of shoreline, designated “urban” by the City of Burien Shoreline Master Program.

- **Streams/Surface water**
Classification of streams
 - Salmon Creek – Type 2 with salmonids (King County Sensitive Area Map Folio)
Department of Natural Resources (DNR) Type 3 waters lower stream stretch, Type 4 waters upper stream stretches
Approximately 4,900 lineal feet (main stream channel), approximately 6,400 lineal feet of mapped tributaries

 - South Salmon Creek tributaries – Unclassified by King County Sensitive Area Map folio.
DNR classifies as Type 5 waters
Approximately 6,700 total lineal feet

Goal NE 8.1

Eliminate fish blockages and return fish to Salmon Creek.

Discussion: Implementation strategy for returning salmon to the creek should include the development of a restoration plan to address possible impacts to and surrounding Salmon Creek. The plan should address issues including but not limited to increased wildlife population (raccoons) attracted to the restored creek that could become a nuisance in the neighborhood.

Goal NE 8.2

Organize, educate, and conduct water quality volunteer programs that are pertinent to the restoration of Salmon Creek. The programs should be structured using scientifically recognized methods to ensure validity and usefulness of information and knowledge obtained through the program.

Policy NE 8.2.1 Stream restoration efforts should include an educational component to benefit younger generations.

Policy NE 8.2.2 The neighborhood should work with and utilize expertise of other agencies such as the Department of Ecology and King County to assist in restoring Salmon Creek.

Policy NE 8.2.3 The City should provide opportunities for education regarding techniques and methods to reduce the impacts of stormwater run off and water quality.

Goal NE 8.3

Improve natural conditions of Salmon Creek to an environmental quality level that encourages and supports the return and continuation of salmon runs in the creek.

Policy NE 8.3.1 The City should incorporate low impact development practices to reduce the amount of stormwater run off.

Policy NE 8.3.2 The City should improve water quality with the use of catch basin inserts. This method should generally be used in basins that are most susceptible to debris and contaminants.

Goal NE 8.4 Protect and Preserve the Natural Environment

Protect and preserve the natural environment and provide opportunities for residents to experience nature without adversely affecting environmental quality.

Goal NE 8.5 Restore the Natural Environment
Restore degraded critical areas with native species.

Policy NE 8.5.1 Develop vegetation restoration plans and/or programs to restore natural open spaces.

9.0 PARKS AND OPEN SPACE

The Salmon Creek neighborhood includes a variety of parks and open spaces. The following is a summary of those spaces located within the Salmon Creek neighborhood (See Map 1.1).

Salmon Creek Ravine

Size: 92.79 Acres

Use Description: Conservancy Park, Open Space Park (per park plan, May 2000)

A passive park with a series of trails and access roads

Natural features include Salmon Creek and a number of small tributaries feeding into Salmon Creek. The Park contains some wetlands associated with the creek and feeder tributaries. Other characteristics include second growth timber and a variety of wildlife.

Shorewood Park

Size: 3.4 Acres

Use Description: Neighborhood Park (per comprehensive plan), Open Space Park (per park plan, May 2000)

A passive park that is mostly wooded with large trees and sloping topography. A path exists in the park which connects 28th Avenue SW to the Shorewood Elementary School.

Shorewood School

Size: 1.4 acre play field.

Use Description: Neighborhood Park (per comprehensive plan), Sports Field (per park plan)

An active park. Activities including baseball and soccer fields, hard surface play areas. Although not an official city park it is used for active recreation activities by the neighborhood.

New Park on Ambaum Boulevard (North Ambaum Park)

Size: 1.02 Acres

Use Description: Neighborhood Park

Park is designed for active and passive uses including a play toy, basketball court, plaza, restroom and parking. The design phase is scheduled to conclude in fall of 2004 with construction scheduled for 2005 contingent on funding from grant sources.

Parks and Open Spaces abutting the Salmon Creek Neighborhood

Seahurst Park

Size: 168.8 Acres

Use Description: Regional Park

Seahurst Park is a park with a significant amount of open space and natural features such as streams, wetlands and Puget Sound shoreline. Park also includes a marine technology facility, an extensive trail system and recreational structures.

Seola Park - (In City of Seattle)

Size: 14.6 Acres

Use Description: Woods (Open Space)

A passive greenbelt park with designated view areas.

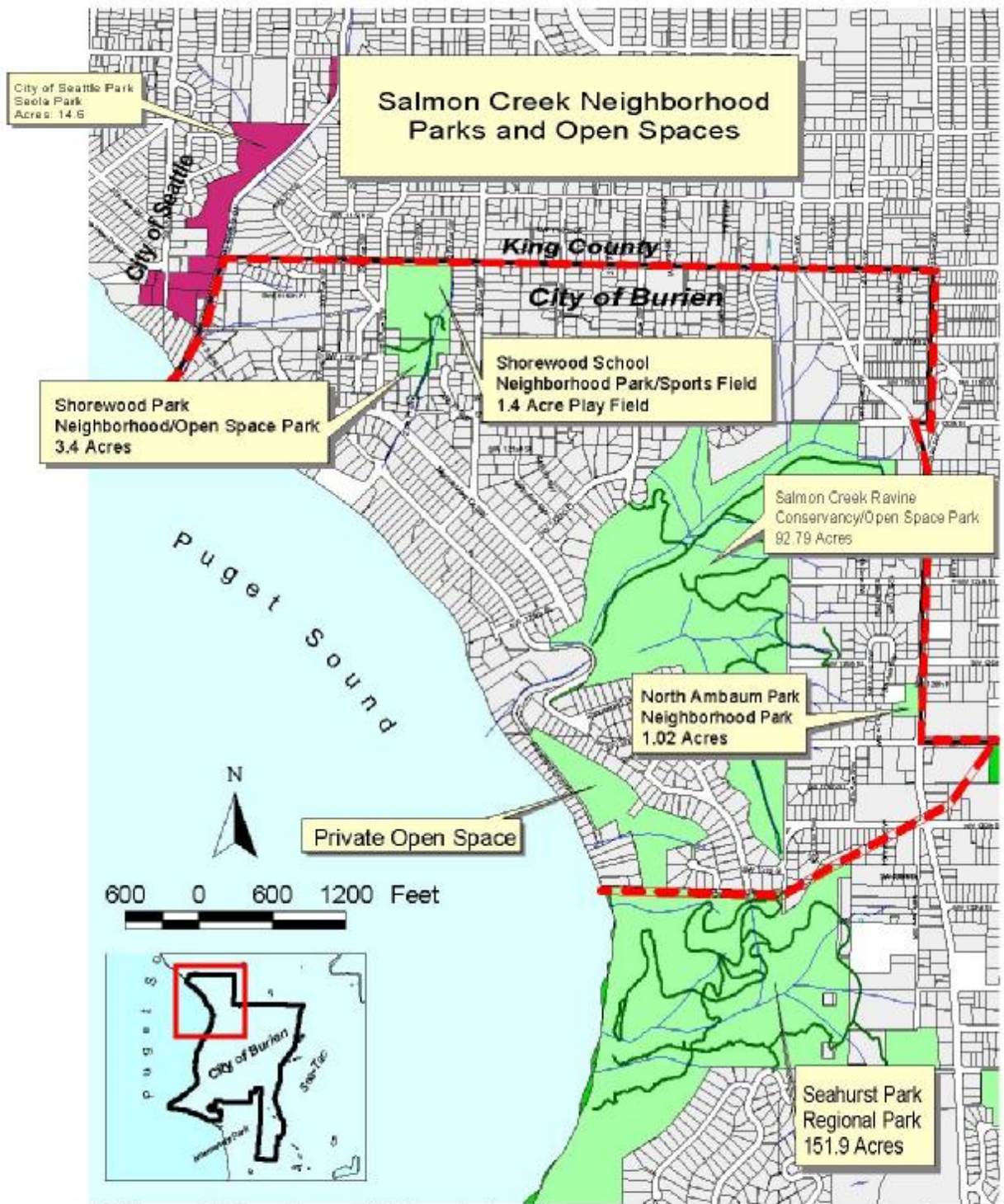

City of Burien, Washington June 2004

Salmon Creek Neighborhood Plan Map 9.1

- Salmon Creek Neighborhood Boundary*
- City of Burien Boundary*
- Trail*
- Stream*

Goal PK 9.1 Parks and Open Space

The neighborhood should have an equal distribution of comparable park facilities throughout the neighborhood with good access for all residents and increase opportunities for active recreation spaces and activities within the neighborhood.

Policy PK 9.1.1 Preserve options now for park land needs of the future.

Policy PK 9.1.2 Provide more park access to all residents of the neighborhood, especially residents of multi-family housing. Signage for all existing parks shall either be installed and/or improved to help identify park and open space locations and access points.

Policy PK 9.1.3 Where opportunities arise, increase the number of pocket parks throughout neighborhood.

Discussion: Equal distribution of parks throughout the neighborhood is very important. The price of land keeps escalating along with the opportunities to acquire larger parcels. To implement the goal stated above, the Salmon Creek neighborhood recommends that the following sites be acquired by the City (see Map 1.2).

Potential Park Location No. 1

11729 21st Avenue SW

Total Area = 20, 259 Square feet (0.47 Acres)

KC Tax parcel No. 074500-0025

Potential Park Location No. 2

Parcel(s) west of Mark Manor Apartments

Total Area = 11.39 Acres

KC Tax parcel Nos. 374460-0251, 374460-0300, 374460-0305, 374460-0440, 374460-0470

Potential Park Location No. 3

Vacant lot on SW 128th immediately west of 12731 SW 128th Street

Total Area = 36,202 Square feet (0.83 Acres)

KC Tax parcel No. 374460-0950

Potential Park Location No. 4

Vacant lots at the intersection of SW 116th Street and Ambaum Blvd. SW

Total Area = 14,599 Square feet (2.63 Acres)

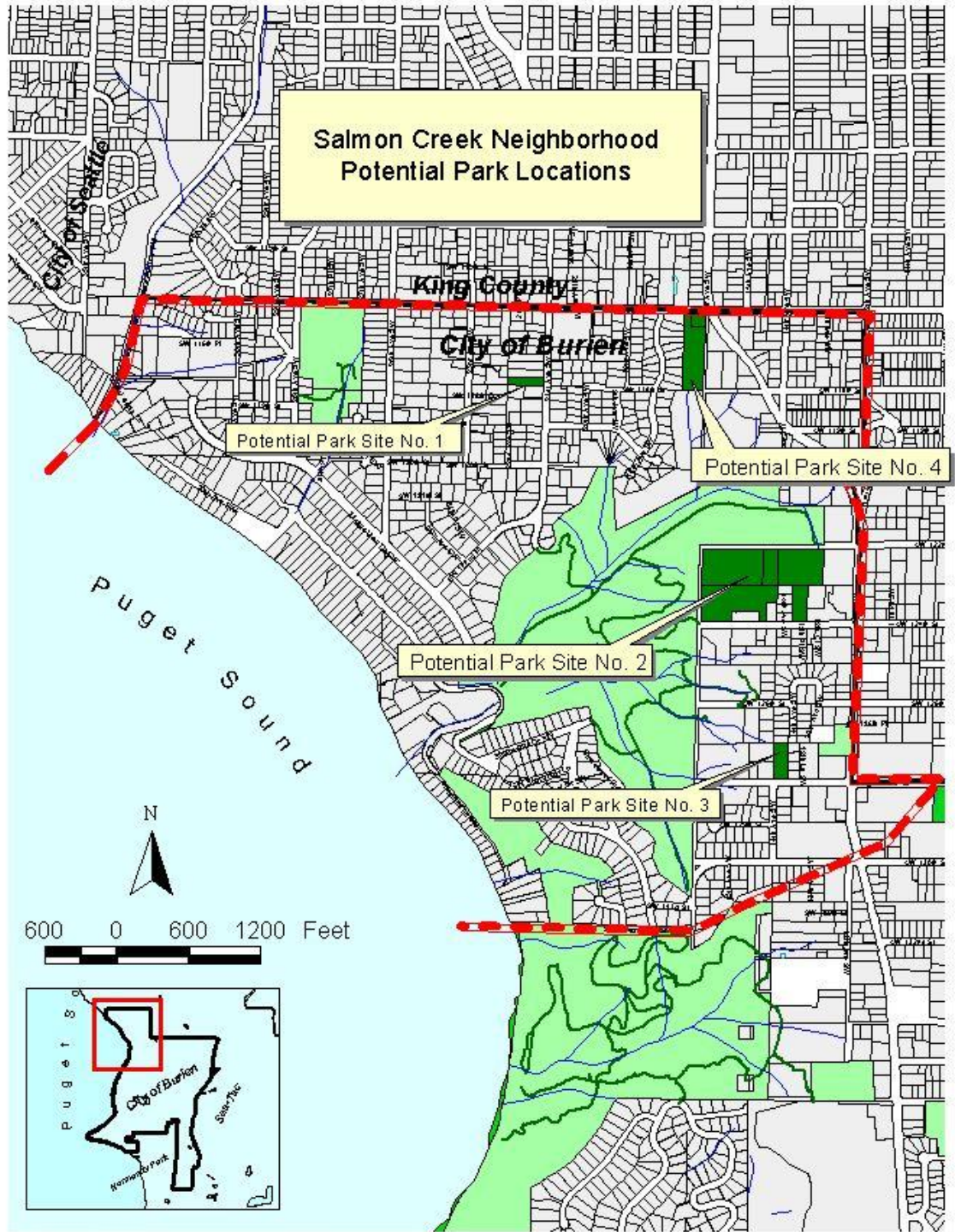

KC Tax parcel Nos. 122303-9006, 122303-9216



City of Burien, Washington
Salmon Creek Neighborhood Plan

June 2004

Map 9.2

 *Salmon Creek Neighborhood Boundary*
 *City of Burien Boundary*

- Policy PK 9.1.4** Incorporate and utilize voluntary methods to preserve and maintain existing open spaces. Methods to preserve and maintain existing opens spaces could include; private land donations to the City and/or recording of conservation easements.
- Policy PK 9.1.5** Work with the Southwest Suburban Sewer District to obtain access to Salmon Creek and the Salmon Creek Ravine. Create well defined entry points and creek viewing areas.
- Policy PK 9.1.6** Existing stands of significant trees in the Salmon Creek Neighborhood are to be preserved to the greatest extent possible.

10.0 PUBLIC SAFETY

Goal PS 10.1 Public Safety

Residents of the Salmon Creek Neighborhood are to have current public information concerning personal safety and property protection readily available on the internet and through a neighborhood network to further disseminate the information for use.

Policy PS 10.1.1 A neighborhood block watch system is to be established to help facilitate communication throughout the neighborhood for day-to-day public safety issues and to be in place for the neighborhood to effectively respond to emergency conditions.

Goal PS 10.2 Provision of Public Safety Services

The residents of the Salmon Creek Neighborhood are to be protected by qualified, trained public safety specialists. The provision of public safety services should include the ability to respond to unique emergencies such as hazardous materials, special rescue, suspected explosives, etc.

Policy PS 10.2.1 The City should support consolidation or administrative coordination among local fire departments in the Highline area so that specialized response teams are formed and trained to address a range of emergency conditions for response throughout the area and the Northwest Neighborhood.

Policy PS 10.2.2 The City should actively work with water utility service providers to ensure that areas of low water flow are upgraded to ensure that adequate service is provided. In addition adequate water service shall meet acceptable minimum requirements for the provision of emergency fire response services.

Policy PS 10.2.3 The City should adequately maintain the existing street lighting to help support public safety.

Discussion: The Steering Group felt that there is generally an adequate amount of street lighting however vegetation is obscuring the existing lighting. The Steering Group recommends that the City should more actively trim vegetation to ensure the lighting that is available can be used to its fullest potential thereby helping with concerns regarding public safety.

11.0 APPENDICIES

11.1 History

Early Settlers Indexed by Date of Land Transfer Authority

Range	Township	Section	Year	Month	Day	Name	Acres	Description
23N	3E	12	1864	12	9	Oulet, George	70.55	Lot 2 of N half of SW, Lot 1 or
SWSE1/4								
23N	4E	13	1866	3	6	Brownell, Charles E.	321.32	Entire Section
23N	4E	14	1866	3	6	Brownell, Charles E.	321.32	Entire Section
23N	4E	23	1866	3	6	Gillman, William H.	159.38	Entire Section
23N	4E	24	1866	3	6	Gillman, William H.	159.38	Entire Section
23N	4E	24	1866	3	6	Meador, Henry (Heirs of)	160.10	Entire Section
23N	4E	25	1866	3	6	Meador, Henry (Heirs of)	160.10	Entire Section
23N	4E	24	1866	10	10	Hill, John S.	146.95	SENE, NESE, Lot 2 (NWNE1/4), Lot 3 (NENE1/4), Lot 4 (NENE1/4)
23N	3E	13	1869	5	15	Pope, A.F.	136.90	E1/2SE, Lot 1. Lot 2 or NWSE1/4
23N	3E	13	1869	5	15	Talbot, W.C.	136.90	E1/2SE, Lot 1. Lot 2 or NWSE1/4
23N	3E	13	1869	5	15	Walker, Cyrus	136.90	E1/2SE, Lot 1. Lot 2 or NWSE1/4
23N	4E	13	1869	5	15	Richardson, Edwin	3.95	Lot 2 (SESW1/4)
23N	4E	13	1869	5	15	Richardson, Edwin	80.00	E1/2NE
23N	4E	12	1870	5	2	Dean, Peter	80.00	NWNE (White Center), SESE (Salmon Creek-Goat Hill)
23N	3E	13	1870	9	9	Parker, John G.	9.70	Lot 3 or SWNE1/4
23N	4E	13	1870	10	20	Richardson, Edwin	12.00	Lot 7 (NESW1/4)
23N	4E	30	1870	10	20	McAleer, Hugh	318.50	SE, E1/2SW, NWSW, SWSW
23N	4E	13	1871	6	5	Wyckoff, Lewis V.	157.95	Lot 4 of SWSE, Lot 5 of SESW, Lot 6 of SWSW
23N	4E	23	1871	6	5	Wyckoff, Lewis V.	157.95	Lot 1 of SENE, Lot 2 of NENE
23N	4E	24	1871	6	5	Wyckoff, Lewis V.	157.95	NENW, Lot 1 of NWNW, Lot 5 of SWNW, Lot 6 of SENW
23N	3E	12	1871	10	10	Stone, C. P.	37.25	Lot 3 (SWNW1/4)
23N	4E	6	1871	10	10	Foster, H.W.	156.74	NWSW, SWSW
23N	4E	7	1871	10	10	Foster, H.W.	156.74	NWNW, SWNW
23N	4E	21	1871	10	10	Krouskop, A.H.	400.00	NE, N1/2NW, N1/2SW, SENW,
SESE								
23N	3E	12	1872	5	1	Ferry, C.P.	44.75	Aliquot Part 1
23N	4E	17	1872	5	1	Hyde, Anthony	320.00	S1/2
23N	4E	18	1872	5	1	Bloomfield, H.W.	319.84	SE, E1/2SW, NWSW, SWSW
23N	4E	18	1872	5	11	Salmonon, Edwards S.	319.68	NE, E1/2NW, NWNW, SWNW
23N	4E	12	1872	7	20	Ritz, Phillip 160.00	NW	
23N	4E	12	1872	7	20	Ritz, Phillip 160.00	SW	
23N	4E	24	1872	8	1	Bagley, Daniel	126.60	SWNE, NWSE, Lot 10 (NWSW1/4), Lot 8 (NESW1/4)
23N	4E	12	1872	10	10	Bott, Joseph J.	157.25	NESE, SWNW, NWSW, Lot 10 of NWNW, Lot 9 of NENW
23N	4E	19	1873	11	15	Cushman, William H.	41.70	Lot 1 (NESE1/4), Lot 1 (NWSW1/4)
23N	4E	13	1874	5	28	Washington State	141.20	N1/2SE, SESE, Lot 3 (SWSE1/4)
23N	4E	12	1875	1	5	Parks, Daniel	160.00	W1/2SE, SWNE, SESE
23N	4E	20	1879	3	1	Kelly, Michael	80.00	S1/2NE
23N	4E	20	1879	3	1	Steele, James T.	80.00	N1/2SW
23N	4E	20	1886	6	30	Wood, James Henry	160.00	E1/2SW
23N	4E	29	1886	6	30	Wood, James Henry	160.00	N1/2NW
23N	4E	20	1887	10	14	Bissell, John 80.00	W1/2SW	
23N	4E	20	1887	10	14	Kelly, Michael	80.00	N1/2NE
23N	4E	7	1888	1	25	Huntington, John	160.00	W1/2NE, E1/2NW
23N	4E	17	1888	1	28	Pontius, Albert M.	160.00	NW
23N	4E	17	1888	1	28	Pontius, Margaret J.	160.00	NE
23N	4E	18	1888	1	28	Julian, Edwin P.	160.00	NE
23N	4E	19	1888	1	28	Brown, Mary T.E.	160.00	NE
23N	4E	18	1888	3	4	Rickards, Albert	159.68	E1/2NW, NWNW, SWNW
23N	4E	29	1889	2	2	Quinn, Patrick	160.00	N1/2SW, SWSW, NWSE
23N	4E	12	1889	7	19	Bellew, Edward	80.00	E1/2NE
23N	3E	12	1889	8	8	Kennett, Charles	120.00	N1/2SE, SESE
23N	3E	12	1889	8	8	Lavender, John	120.00	N1/2NW, SENW
23N	4E	19	1889	8	8	Carter, James	160.00	SE
23N	4E	30	1889	8	8	Walt, Robert	160.82	E1/2NW, NWNW, SWNW
23N	3E	12	1889	8	31	Peacock, Charles	160.00	NE
23N	4E	19	1889	8	31	Burian, Gottlieb	120.86	E1/2SW, SWSW
23N	3E	13	1889	9	3	Blackwell, William J.	100.65	E1/2NE, Lot 4 or NWNE1/4
23N	4E	20	1889	9	3	Brown, Charles R.	160.00	NW
23N	4E	29	1889	9	3	Robbins, Emmett L.	80.00	S1/2SE
23N	4E	7	1889	9	6	Swan, Charles F.	80.00	W1/2SE
23N	4E	20	1889	9	27	Quinn, Joseph	160.00	SWSE
23N	4E	29	1889	9	27	Quinn, Joseph	160.00	W1/2NE, SENW
23N	4E	28	1890	7	3	Paul, Frank H.	160.00	NE

Range	Township	Section	Year	Month	Day	Name	Acres	Description
23N	4E	19	1890	11	22	Murphy, William	160.42	E1/2NW, NWNW, SWNW
23N	4E	30	1891	2	19	Elsley, John C.	160.00	NE
23N	4E	7	1891	3	28	Bartlett, Truman	160.00	E1/2E1/2
23N	4E	21	1891	5	23	Paul, James B.	40.00	SWSE, W1/2NE, SENW
23N	4E	7	1891	8	4	Smith, Henry G.	159.69	E1/2SW, NWSW, SWSW
23N	4E	28	1891	10	13	Wharton, Samuel D.	160.00	SE
23N	4E	21	1892	4	9	West, David W.	160.00	SW
23N	4E	20	1892	4	23	Legett, William M.	160.00	SESE
23N	4E	29	1892	4	23	Legett, William M.	160.00	E1/2NE, NESE
23N	4E	19	1892	8	8	Meacham, George F.	0.75	Lot 2 (NWSW1/4)
23N	4E	29	1892	8	20	Peplan, Adolph	40.00	SESW
23N	4E	28	1892	11	28	Clark, Samuel G.	160.00	SW
23N	4E	29	1893	4	29	Clark, William S.	40.00	SWNE
23N	4E	28	1894	2	28	Paul, Albert	160.00	NW
23N	4E	21	1894	11	30	Hamilton, Marquis L.	40.00	SWNW
23N	4E	24	1895	6	19	Larsen, Niels P.	29.40	Lot 13 of SESE, Lot 14 of SWSE
23N	4E	13	1901	4	9	Rogers, Lyman H.	80.00	N1/2NW
23N	4E	13	1901	11	11	Bagley, Kitte	80.00	W1/2NE

23-3-B

Township 23 N. Range 3 E. N. 4

Plat of the land of 1892-1901

*Departments of the Interior
General Land Office
March 16 - 1894*

I hereby certify that the above is a true photo lithographic copy of the original on file in this Office.

Claring Comstock

Survey description	By whom made	Date made	Acres	When surveyed	West boundary
1/2 NW 1/4 Sec 19	J. S. Paul	1890	160.42	11/22/90	1/2 NW 1/4 Sec 19
1/2 NE 1/4 Sec 19	J. S. Paul	1890	160.42	11/22/90	1/2 NE 1/4 Sec 19
1/2 SW 1/4 Sec 19	J. S. Paul	1890	160.42	11/22/90	1/2 SW 1/4 Sec 19
1/2 SE 1/4 Sec 19	J. S. Paul	1890	160.42	11/22/90	1/2 SE 1/4 Sec 19
Total area of	160.42				

The above map of Township 23 North, Range 3 East, North 4, of the Willamette Meridian in the Territory of Oregon, is strictly conformable to the field notes of the Surveyors of on file in this office, which have been examined and approved.

*Surveyor General Office at
Salem, Oregon, March 16 - 1894*

*Arthur G. Henry
Surveyor General, Oregon*

11.2 Housing

The following is a summary of housing in the Northwest Neighborhood. To assist in understanding of the data comparisons were made with the entire City of Burien as well as King County.

		NW Neighborhood	City of Burien	King County
Average age of housing		1959	1955	N/A
Housing units		1,417	14,024	742,237
	MFR	25%	39%	37%
	SFR	75%	61%	63%
Owner Occupied Units (%)		66%	54%	57%
Vacant Units		3%	4%	4%
Median housing value		\$139,220*	\$175,000	\$236,900
Median rent		\$466*	\$612	\$696
Average Household size		2.46	2.34	2.39
		(TIGER 2000/arcview and KC Assessor)	(PSRC Cen 2000, Oct. 2002)	(PSRC Cen 2000, Oct. 2002)

*- Note: Values were based on data available at the time and may not reflect the current rental and housing prices.

11.3 People of the Neighborhood

The following is a summary of population in the Northwest Neighborhood. To assist in understanding of the data comparisons were made with the entire City of Burien as well as King County.

		NW Neighborhood	City of Burien	King County
Total Population		3,373	31,744	1,737,034
Race	White	71%	80%	79%
	Black	6%	6%	7%
	Native American	2%	3%	2%
	Asian	10%	9%	13%
	other	12%	8%	5%
			psrc SF1(2000)	psrc SF1(2000)
Median age		36 (est)	38.40	35.70
Median income		\$38,232	\$41,577	\$53,157
Education				
	High School	20%	27%	19%
	Assoc/some college	23%	8%	8%
	Bachelors	12%	15%	27%
	Higher	5%	4%	10%
		(TIGER 2000/arcview and KC Assessor)	(PSRC Cen 2000, Oct. 2002)	(PSRC Cen 2000, Oct. 2002)

11.4 Northwest Neighborhood Service Districts

- § School District
Highline School District No. 401
15675 Ambaum Blvd. SW (206) 433-0111 www.hsd401.org
Burien, WA 98166
- Shorewood Elementary School
 - Hazel Valley Elementary School
 - Salmon Creek Elementary School
 - Cascade Middle School
 - Evergreen High School
- § Highline Community College www.highline.ctc.edu
2400 South 240th Street (206) 878-3710
P.O. Box 9800
Des Moines, WA 98198-9800
- § South Seattle Community College www.southseattle.edu
6000 16th Avenue South (206) 764-5300
Seattle, WA 98106
- § Power (Seattle City Light) www.cityofseattle.net/light
3613 4th Avenue South (206) 625-3000
Seattle, WA 98134
- § Water Districts
- Seattle Water Department
710 2nd Avenue South 10th Floor (206) 684-5900 check www.cityofseattle.net/util
Seattle, WA 98104-1714
- Water District 20
12606 1st Avenue South (206) 243-3990
Seattle, WA 98168
- § Sanitary Sewer Service Provider
Southwest Suburban Sewer District
413 Ambaum Blvd SW (206) 244-9575
Burien, WA 98166
- § Fire Service Provider www.northhighlinefd.org
North Highline Fire District (King County Fire District 11) (206) 243-0033
1243 SW 112th Street
Seattle, WA 98146
- § Religious Institutions (in neighborhood or within one block of neighborhood boundary)
- St. Pauls of Shorewood
 - Four Square Church
 - St. Bernadette
- § Other www.shorewoodonthesound.org
- Shorewood Community Club
Post Office Box 47203
Burien, WA 98146